



AWS Quote/Order Checklist

C.R. Laurence Co.

CRL offers complete Windscreen Kits and Components. We are also able to custom fabricate to your specification. Please contact Technical Sales for a quote today, or simply fax this form to (800) 587-7501 (U.S.), or (323) 584-5289 (Canada and International).

Company Name _____
 Contact _____
 Job Name _____

Phone # _____
 Fax # _____
 Date _____

WINDSCREEN SYSTEM

- Rectangular 2" x 2-5/8" (50.8 x 66.7 mm)
- Round 3" (76.2 mm) Diameter

POSTS NEEDED

- Ends _____
- 90 Degree Corners _____
- 180 Degree Centers _____
- 135 Degree Centers _____

POST ATTACHMENT

- Core Mount
- Fascia Mount
- Surface Mount
- Other _____

POST HEIGHT

- 36" (914 mm)
- 48" (1219 mm)
- 60" (1524 mm)
- 72" (1829 mm)
- Other _____

SUBSTRATE

- Concrete
- Steel
- Wood
- Other _____

GLASS THICKNESS

- 1/4" (6 mm)
 - 3/8" (10 mm)
 - 1/2" (12 mm)
 - Other _____
- (Glass not supplied by CRL)



COLOR

- Sky White
- Oyster White
- Agate Gray
- Beige Gray
- Forest Green
- Matte Black
- Matte Bronze
- Clad in Polished S.S. w/Flat Cap
- Clad in Satin S.S. w/Flat Cap
- Special (Specify) _____

BOTTOM RAIL LENGTH (OPTIONAL)

- 36" (914 mm)
- 48" (1219 mm)
- 60" (1524 mm)
- 72" (1829 mm)
- No Bottom Rail
- Other _____

FLOOR CONDITION

- Flat
- Sloped (Degrees) _____

Basic Installation Guidelines

(Complete Instructions Will Be Included With Each Kit)

- 1
 - ✓ Core mount or surface mount the Steel Stanchions, starting with the End and Corner Posts first, using expanding cement.
 - ✓ Then run a straight line between your End Posts and/or Corner Posts before you set the Intermediate Posts.
 - ✓ Be sure the Stanchions are plumb and level.

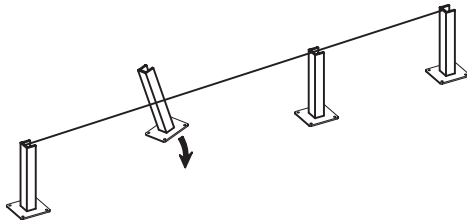

- 2
 - ✓ Once the Steel Stanchions are installed, apply CRL 95C Silicone to the Stanchion before mounting the Post into place.
 - ✓ If you are installing a Bottom Rail, measure and cut to the desired size, then install the Bottom Rail onto the substrate using CRL 95C Silicone.
 - ✓ **NOTE:** Bottom Rails are optional when installing the AWS System.

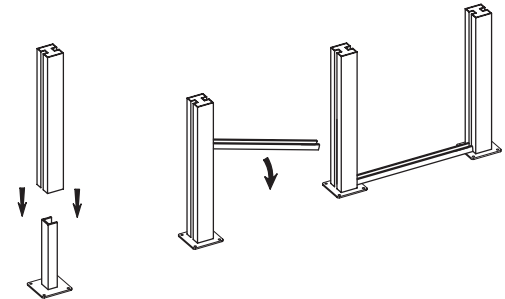

- 3
 - ✓ When installing the glass panels, make sure the rigid vinyl is installed into the glass pocket before installing the panels.
 - ✓ Slide the glass panels down from the top of the Post. Make sure the vinyl is lubricated to protect the vinyl from damage during installation.

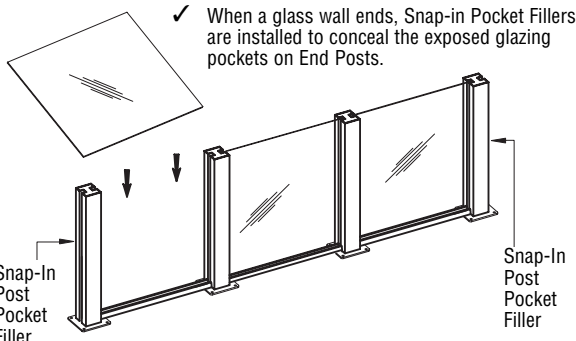

- 4
 - ✓ Install Post Caps with CRL 95C Silicone.
 - ✓ To protect the glass from debris over time, use Cat. No. TPC16 Surface Protector to seal the glass.

