

Basic Installation Instructions For CRL7750 Series Sunshades

1. Outrigger Installation

First, layout and verify all centerline dimensions. Next, install the two outermost Outriggers plumb and level to the substrate. Then, shoot a line from Outrigger to Outrigger, to find the depth dimension of the outer line. Proceed with the installation by attaching the middle Outrigger, shimming as required (see pages M284-M285 for shims). Note: Verify again all centerline dimensions.

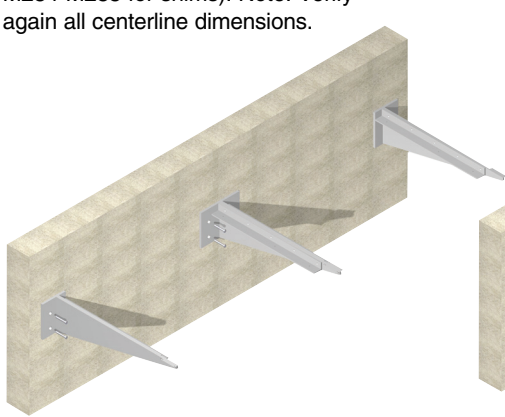

2. Fascia Installation

Once all the Outriggers are shimmed and anchored correctly to the substrate, proceed with the installation of the Fascia. Using the supplied screws secure the Fascia to the Outriggers as shown below.

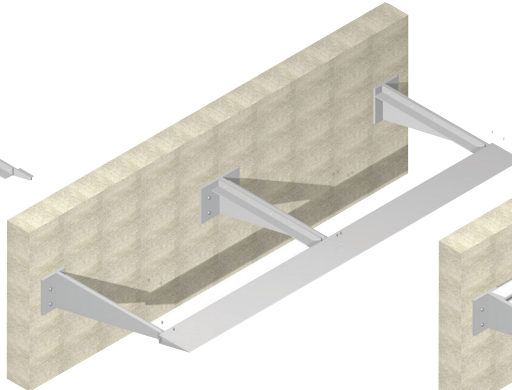

3. Infill Installation

After the Outriggers and Fascia have been mechanically fastened, proceed with anchoring the Stainless Steel Corrugated Metal Infill to the Outriggers with the supplied screws as shown below.

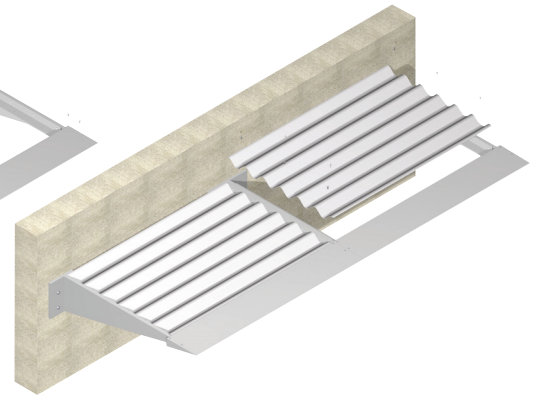

Basic Installation Instructions Typical Sunshades

1. Wall Bracket Installation

First, layout and verify all centerline dimensions. Next, install the two outermost Wall Brackets plumb and level to the substrate using the proper anchor. Proceed with the installation by attaching the middle Wall Bracket, shimming as required (see pages M284-M285 for shims). Note: Verify again all centerline dimensions.

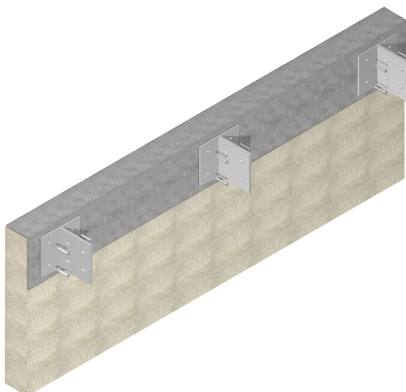

2. Sunshade Installation

Once all the Wall Brackets are anchored correctly to the substrate, proceed with the installation of the Sunshade unit. Using the supplied stainless steel screws, secure the end Outrigger to the End Wall Bracket. Next, bring in the other Sunshade unit and attach both Sunshades together at the Center Wall Bracket using the supplied stainless steel bolts as shown below.

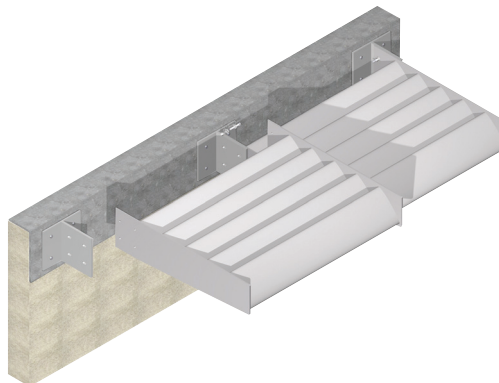

3. Sunshade Installation (Continued)

After the Center Outriggers have been mechanically fastened, proceed with anchoring the other end of the Sunshade unit to opposite End Wall Bracket. Finally, confirm all fasteners are tightened properly.

